

CONTROL VALVES

SOLENOID VALVES EVSI SERIES



Danfoss

DESCRIPTION

The **Danfoss EVSI Series solenoid valves** are two-way, two-position valves for clean water or low pressure steam applications and are available in normally closed or normally open operation. **EVSI Series** valves are pilot-operated and designed for non-water hammer operation. They come completely assembled with coil and are UL Recognized and CE Approved. The coils also include a gasketed conduit connector for NEMA 4 (IP65) environmental rating.

FEATURES

- **Anti-water hammer design**
- **For hot or chilled water and low pressure steam**
- **Fully encapsulated molded coils**
- **1/2" threaded conduit connection**
- **Enclosed screw terminals**
- **NEMA 4 (IP56) environmental rating**
- **Modular conduit connection for easy installation**
- **Unique snap-on coil, no tools required**



EVSI-20-NC-24



3

CONTROL VALVES

DIMENSIONS

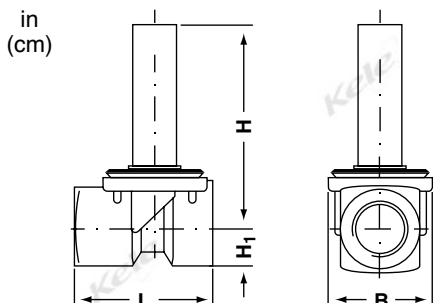

TYPE	NPT	L in (cm)	B in (cm)	H ₁ in (cm)	H* in (cm)	Weight w/o coil lbs (kg)
EVSI 15	0.5"	3.25 (8.3)	2.1 (5.2)	0.6 (1.5)	3.7 (9.4)	1.8 (0.80)
EVSI 20	0.75"	3.7 (9.4)	2.25 (5.8)	0.7 (1.8)	3.9 (9.8)	2.2 (1.0)
EVSI 25	1"	4.6 (11.6)	2.75 (7.0)	0.9 (2.2)	4.25 (10.8)	3.1 (1.4)
EVSI 32	1.25"	4.8 (12.2)	3.25 (8.2)	0.7 (2.7)	4.5 (11.5)	4.4 (2.0)
EVSI 40	1.5"	5.2 (13.2)	3.75 (9.5)	1.25 (3.2)	4.9 (12.4)	7.1 (3.2)
EVSI 50	2"	6.4 (16.2)	4.4 (11.3)	1.4 (3.7)	5.1 (13.0)	9.6 (4.3)

* For normally open valves + 3/16" (0.5 cm). 018F coil weight = 0.75 (0.34)

SPECIFICATIONS

Size	1/2" FNPT to 2" FNPT	Conduit Connection	1/2" NPT
Cv	4.7, 9.4, 12.9, 21, 28, 46.8	Wiring Terminations	Screw terminals inside DIN connector accept 16 to 18 AWG wire; DIN spades on encapsulated coil
Life Expectancy	800,000 cycles minimum	Action	N.C., N.O. (valve body determines action)
Maximum System Pressure	225 psig (1550 kPa) for 1/2" and 3/4" valves; 180 psig (1240 kPa) for 1" to 2" valves	Stroke Time	.04 seconds opening time, 0.35 seconds closing time for 1/2" valves; up to 5.0 seconds opening time, 10.0 seconds closing time for 2" valves
Pressure Drop	Minimum differential pressure 4 psid (30 kPa) to operate the pilot; maximum differential pressure 142 psid (980 kPa)	Manual Override	EVSI-MOM manual override magnet, order separately
Materials		Operating Temperature	32° to 120°F (0° to 50°C)
Of Construction	Brass valve body, EPDM gasket	Enclosure Rating	NEMA 4 (IP65) with waterproof conduit connection
Media Compatibility	Clean hot or chilled water or glycol, steam ≤15 psig	Dimensions	Coil, 2.5"H x 1.8"W x 2.4"D (5.7 x 4.6 x 6.1 cm)
Media Temperature Range	14° to 248°F (-10° to 120°C)	Approvals	UL file #MH7648
Supply Voltage	120 VAC, 50/60 Hz; 24 VAC @ 14 VA, 50/60 Hz; 240 VAC, 50/60 Hz	Warranty	1 year
Supply Watts	120 VAC, 50/60 Hz; 24 VAC, 50/60 Hz; 240 VAC, 50/60 Hz		



CONTROL VALVES

SOLENOID VALVES EVSI SERIES

3

CONTROL VALVES

WIRING

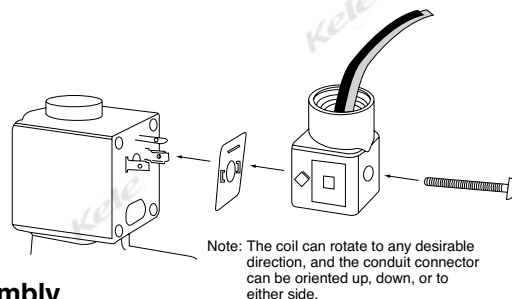
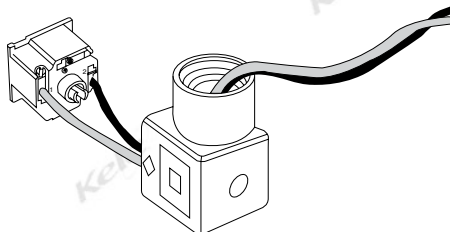
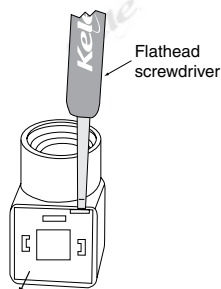
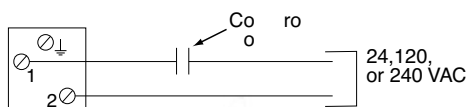

Conduit Connector Assembly

Note: The coil can rotate to any desirable direction, and the conduit connector can be oriented up, down, or to either side.

ORDERING INFORMATION

MODEL	DESCRIPTION
EVSI	Solenoid valve
	SIZE (NPT)
15	1/2", Cv = 4.7, opening time 0.04 sec, closing time 0.35 sec
20	3/4", Cv = 9.4, opening time 0.04 sec, closing time 1.0 sec
25	1", Cv = 12.9, opening time 0.30 sec, closing time 1.0 sec
32	1-1/4", Cv = 21.0, opening time 1.0 sec, closing time 2.5 sec
40	1-1/2", Cv = 28.0, opening time 1.5 sec, closing time 4.0 sec
50	2", Cv = 46.8, opening time 5.0 sec, closing time 10.0 sec
	NORMAL MODE
NC	Normally closed
NO	Normally open
	COIL VOLTAGE
24	24 VAC, 50/60 Hz
120	120 VAC, 50/60 Hz
240	240 VAC, 50/60 Hz

Example: EVSI-15-NC-24 Solenoid valve with 1/2" NPT, normally closed, and 24 VAC coil

ACCESSORIES

018F7655	24 VAC, 50/60 Hz replacement coil only
018F7663	120 VAC, 50/60 Hz replacement coil only
018F7658	208/240 VAC, 60 Hz replacement coil only

RELATED PRODUCTS

EVSI-MOM	Solenoid valve manual override magnet
SSTAG	Stainless steel tag on bead chain, 1" x 2" dogtag, custom engraved per order